

Corner Floor Refrigerated Showcase- 475 L

ITEM: 47708

MODEL: RS-CN-0351-C



Attractively display food merchandise and increase impulse sales.

Showcase your products in style with Omcan's 59" Refrigerated Corner Floor Glass Display Case. Its spacious design is ideal for busy cafés, bakeries, or shops, with brilliant LED lighting and four-sided double glass for maximum visibility.

Adjustable chrome shelves let you tailor your display, while the digital temperature controller and ventilated cooling system ensure consistent freshness. With automatic defrost and a durable stainless steel base, this unit combines function and elegance for any space.

FEATURES:

- Brilliant LED illumination under each shelf
- Digital temperature controller
- Stainless steel base
- Adjustable chrome plated shelves
- Side double glass
- Automatic defrost
- Ventilated cooling system
- 4 Casters

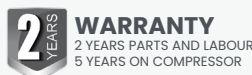

TECHNICAL SPECIFICATION

Item	47708
Model	RS-CN-0351-C
Capacity	475 L / 16.78 cu.ft
Power	650 W
Electrical	110V / 60Hz / 1Ph
Current	2pcs - 15" x 21.7"
Body Material	Stainless Steel
Doors	1 Swing glass door
Number of Casters	5 - 2 with brakes
Number of Shelves	3
Temperature Range	0 - 12°C / 32- 54°F
Energy Consumption	12.37 kW/h
Evaporator Material	Aluminum
Condenser Material	Copper
Refrigerant	R290 / 148g
Lamp Power	70 W
Net Dimensions (WDH)	58.7" x 27" x 55.5" / 1490 x 685 x 1410 mm
Gross Dimensions (WDH)	62.2" x 30.5" x 63.4" / 1580 x 775 x 1610 mm
Net Weight	390.2 lbs / 177 kgs
Gross Weight	526.9 lbs / 239 kgs

TECHNICAL DRAWING

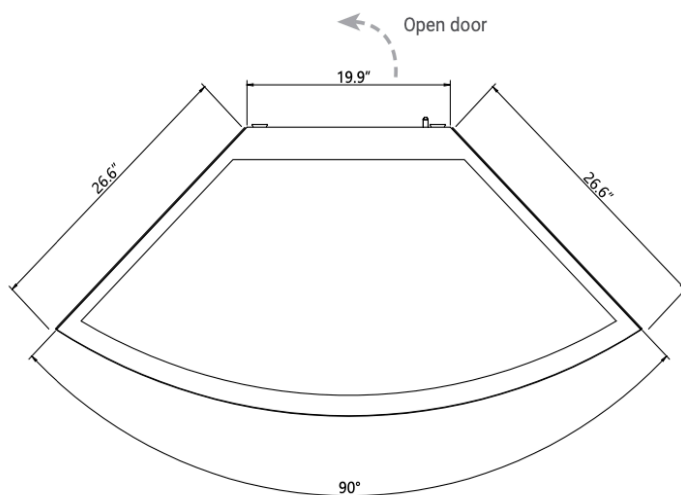
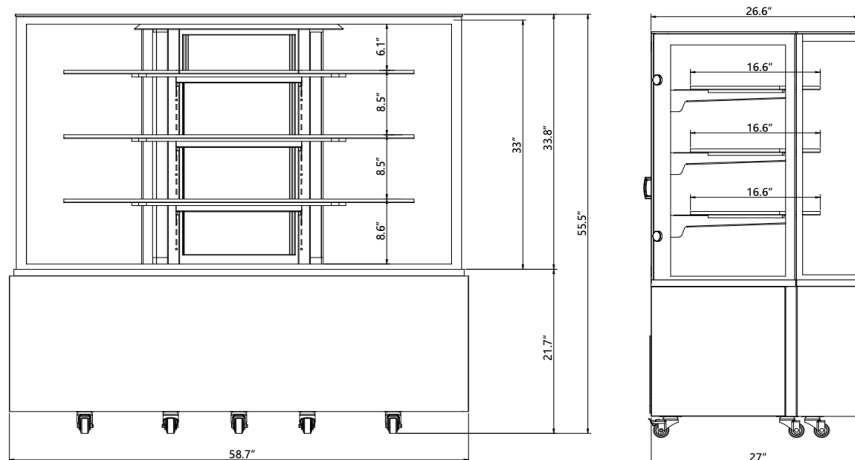

The Omcan 59" Refrigerated Corner Floor Glass Display Case can be matched with the Square Showcases below to make an impressive statement.



ITEM	
44382	36" Square Display Case
44383	48" Square Display Case
44384	60" Square Display Case
44505	72" Square Display Case